

START HERE!

READ ME FIRST

Don't be a hero and muscle through this installation without reading these fitting instructions first! Improper installation of this gear may void certain aspects of your warranty.

Before you begin, take a moment and open all your Front Runner rack kit boxes and gather the assembly instructions for the various components.

A complete kit will contain:

1. A Front Runner Mounting System specific to your vehicle
2. A Front Runner Rack Tray or Load Bar Slats

This document will guide you through the assembly of the mounting system and assist you in fitting the roof rack tray or load bars to your specific vehicle.

Please refer to the next page for a list of all the components, quantities and tools required.

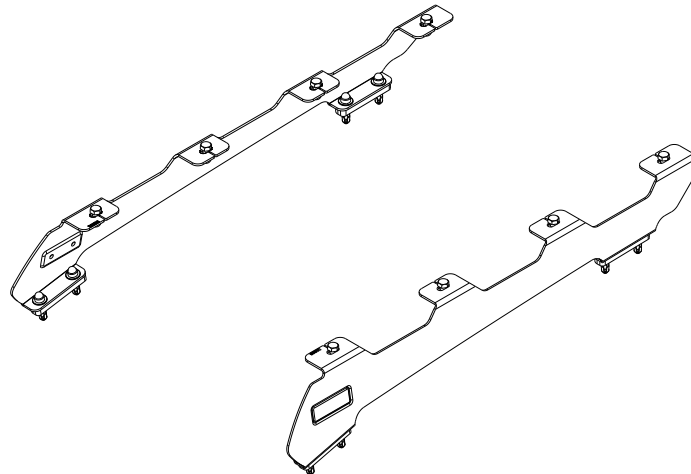

IMPORTANT WARNING! ⚠

IT IS CRITICAL THAT ALL FRONT RUNNER PRODUCTS BE PROPERLY AND SECURELY ASSEMBLED AND ATTACHED TO YOUR VEHICLE. IMPROPER ATTACHMENT COULD RESULT IN AN AUTOMOBILE ACCIDENT, AND COULD CAUSE SERIOUS BODILY INJURY OR DEATH. YOU ARE RESPONSIBLE FOR ASSEMBLING AND SECURING ALL FRONT RUNNER PRODUCTS TO YOUR VEHICLE, CHECKING THE ATTACHMENTS PRIOR TO USE, AND PERIODICALLY INSPECTING THE PRODUCTS FOR ADJUSTMENT, WEAR AND DAMAGE. THEREFORE, YOU MUST READ AND UNDERSTAND ALL OF THE INSTRUCTIONS AND PRECAUTIONS SUPPLIED WITH YOUR FRONT RUNNER PRODUCT PRIOR TO INSTALLATION OR USE. IF YOU DO NOT UNDERSTAND ALL OF THE INSTRUCTIONS AND CAUTIONS, OR IF YOU HAVE NO MECHANICAL EXPERIENCE AND ARE NOT THOROUGHLY FAMILIAR WITH THE INSTALLATION PROCEDURES, YOU SHOULD HAVE THE PRODUCT INSTALLED BY A PROFESSIONAL INSTALLER OR OTHER QUALIFIED PERSONNEL.

NOTE: Front Runner will not be responsible for any damage caused by the failure to install the product according to these instructions.

Please call us if you have any questions about the installation of this product.

1

GET ORGANIZED

IN THE BOX

1	1 X	Foot Rail LH
2	1 X	Foot Rail RH
3	8 X	M8 x 20 Hex Bolt
4	8 X	M8 x 16 x 1.6 Flat Washer
5	8 X	M8 Nyloc Nut
6	8 X	M8 Nut Cap
7	4 X	10mm HDPE Spacer
8	8 X	M6 Jack Nut
9	8 X	M6 x 19 x 1 Flat Washer
10	8 X	M6 x 35 Hex Bolt
11	8 X	M6 Nut Cap
12	1 X	Jack Nut Tool
13	2 X	M6 x 30 Button Head Screw

TOOLS NEEDED

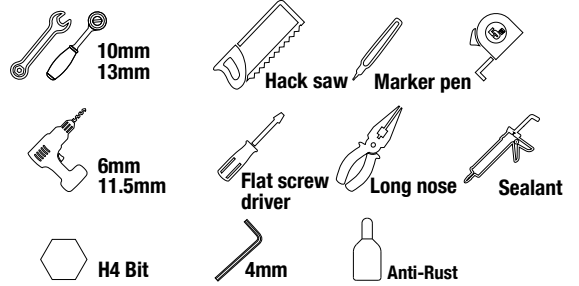
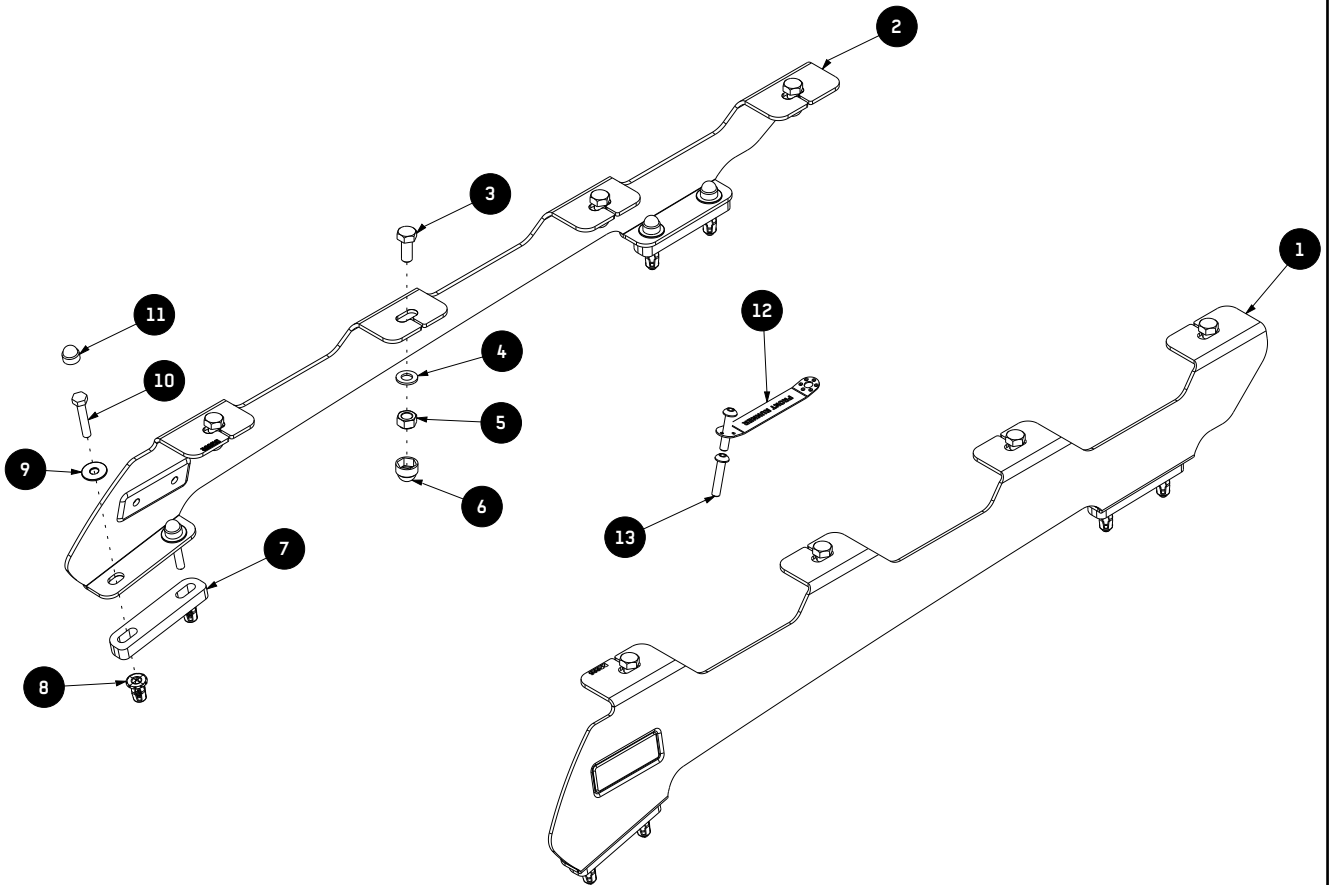
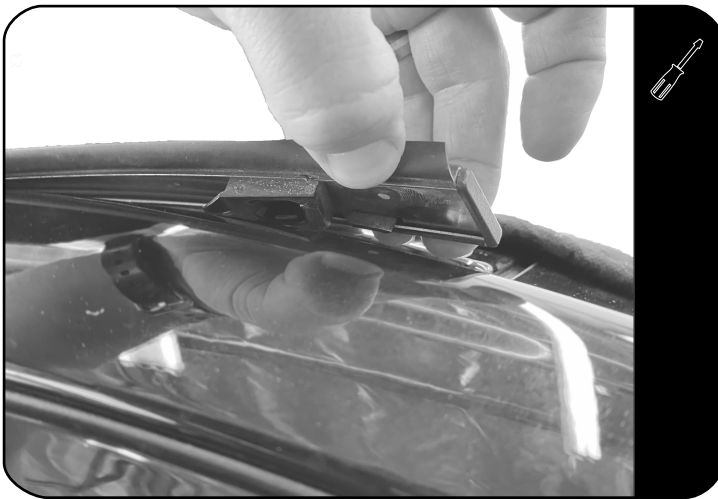

FIGURE 1.1



2.1



Using a flat screw driver and starting from the front of the vehicle, lift and remove the two ditch moldings running along either side of the roof.

2.2

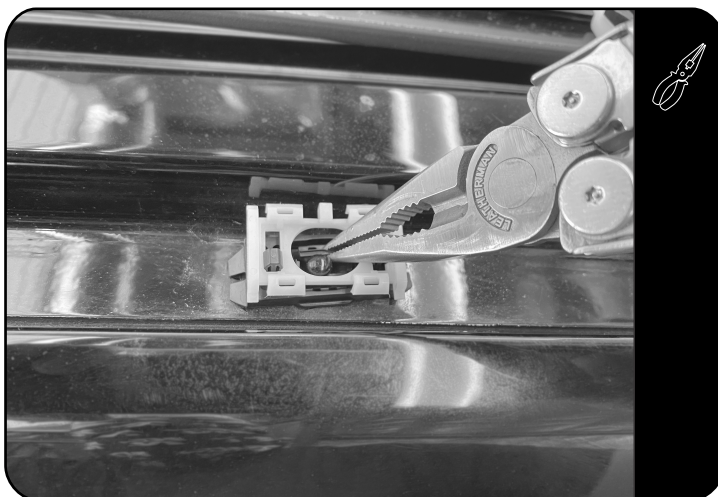

Remove all the retaining clips using a long nose plier as shown.

2.3

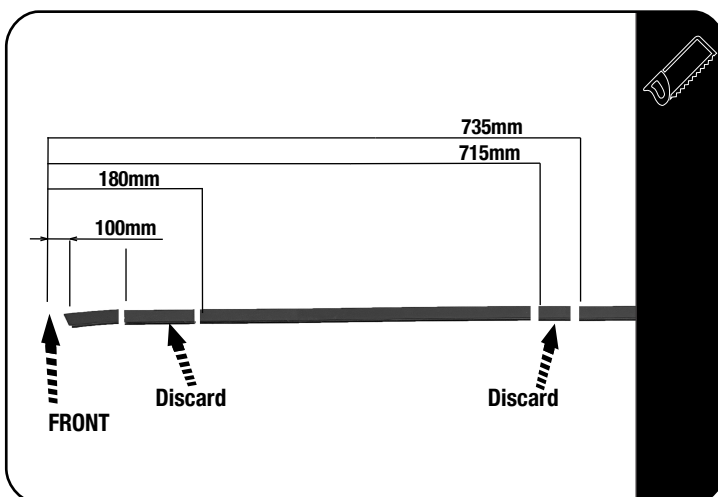

You can choose to remove the ditch molding and clips all together and keep in a safe place should you want to remove the rack and refit them



Lay the left-hand ditch moulding on an even surface. From the front tip of the ditch moulding, measure and mark as shown.

Using a hacksaw, cut the ditch moulding at each marking.

Discard the three smaller pieces and refit the retaining clips to the four cut ditch mouldings making sure the retaining clips line up with the clip pins in the ditch.

Repeat this for the right-hand moulding.

2.4

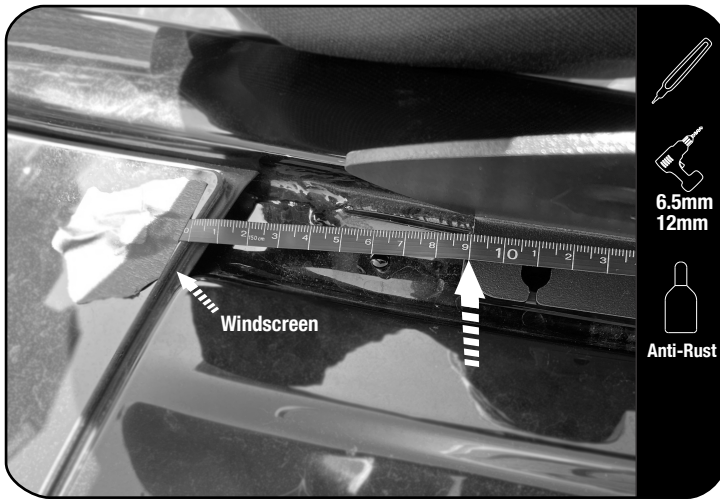

Place the Spacers (Item 7) in the ditch and position the foot rail over the spacers.



Position the foot rail lower front edge 90mm back from the top edge of the windscreen glass as shown

Align the spacers under the foot rail front and rear mounting tabs.

Carefully remove the foot rail taking care not to move the spacers.

Mark the slot centers of the 4 mounting points (2 per spacer)

Start with a 6mm pilot hole and then open the holes using 11.5mm drill.

Apply anti rust on all the holes

2.5

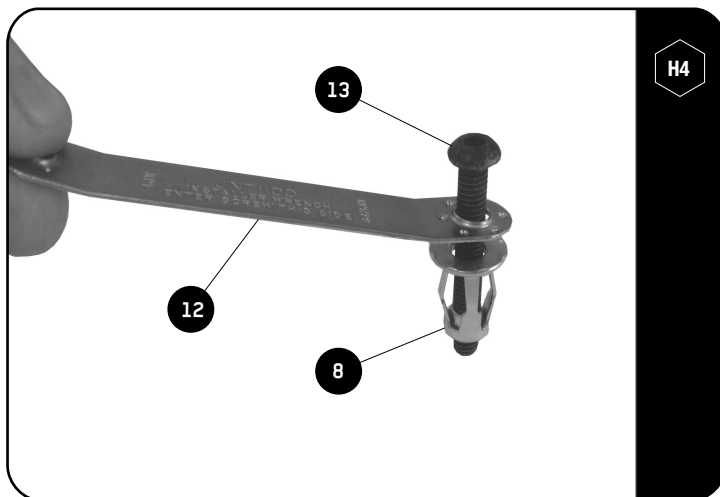

Insert the M6 Button Head screw (Item 13) into the one side of the Jack Nut Tool (Item 12). Loosely fit a Jack Nut (Item 8) to the Button Head Bolt as shown. Using the Jack Nut Tool and a M6 x 30 Button Head Bolt, insert a M6 Jack Nut into all 8 holes. Using a Battery Powered Screw Driver and a H4 Allen Key Bit, set the Jack Nut into the hole while holding onto the handle of the Jack Nut Tool.



Make sure the Jack Nut has pulled up all the way to the inside skin of the roof panel.

2.6



Place sealant around and over all the jack nuts to insure a proper seal.

Place the spacers over the jack nuts. Fill the spacer holes with sealant.

2**FIT AND SECURE**

2.7

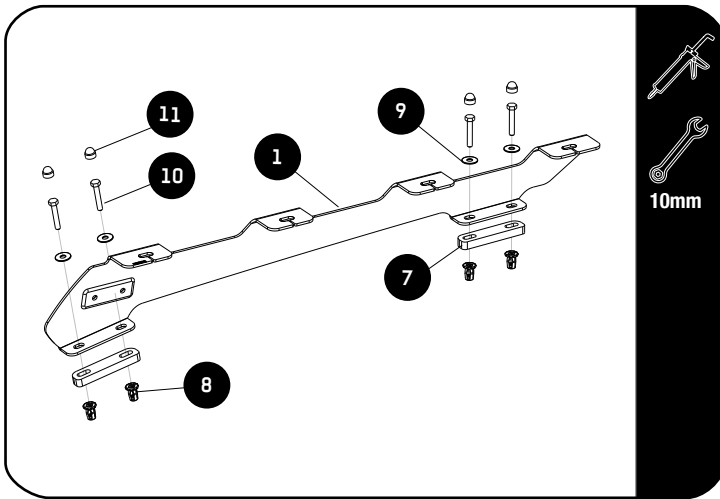

Place the Foot Rail (Item 1) on top of the Spacers (Item 7).

Slide a M6x19x1 flat washer onto all the M6x35 hex bolts (Item 9 & 10). Apply a bead of sealant along the bolt threads and secure the rail to the roof. Do this on both the LH and RH side.

Finish off by placing M6 Nut Caps (Item 11) on the M6 Hex Bolt heads.

To fit the Rack, proceed to Step 3.

3**FIT AND SECURE**

3.1

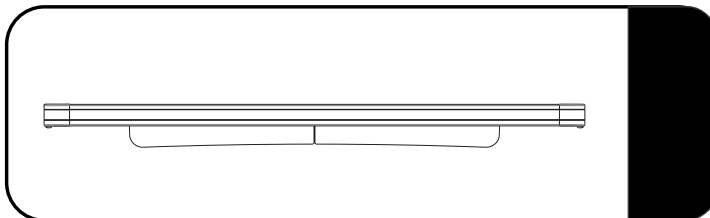

Make sure that the wind deflector is installed before you proceed to the next step.

3.2

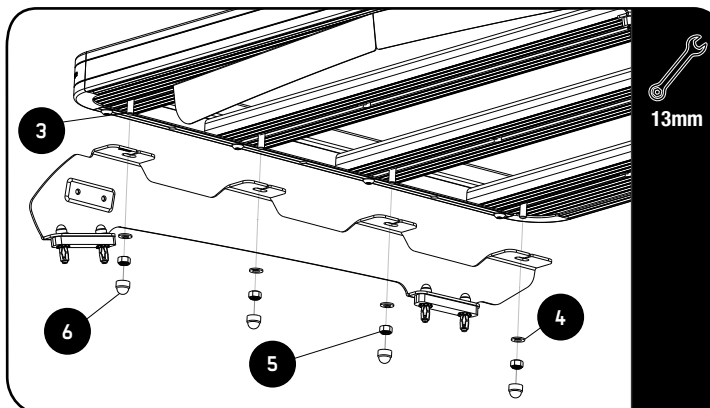

Fit your Roof Rack to the Foot Rails using M8x20 Hex Bolts, M8x16x1.6SS Flat Washers and M8 Nyloc Nuts (Items 3, 4 & 5) as shown.

3.3

Center the rack and tighten fully. Finish off by fitting the M8 Nut Caps (Item 6) on the M8 Nyloc Nuts.



4

INSTALL OTHER VEHICLE AND RACK ACCESSORIES

Now's the time to visit your favorite Front Runner Dealer in person or online.

IMPORTANT!

FRONT RUNNER RACK KITS OFTEN HAVE A HIGHER LOAD RATING THAN THE VEHICLES THEY ARE MOUNTED TO. PLEASE REFER TO YOUR SPECIFIC VEHICLE MANUFACTURER FOR A RECOMMENDED ROOF RATING. FRONT RUNNER CANNOT BE RESPONSIBLE FOR IMPROPER LOADING BEYOND THE VEHICLE MANUFACTURER'S STATED LOAD CAPACITY.

Be sure to tag us. We love to see our gear in action! #FrontRunnerOutfitters #BornToRoam

Share your adventures on: 